

FILE IN:
 DIVISION 5
 SECTION A
 Issued April 1984
 Revised December 1986

TECUMSEH PRODUCTS COMPANY

ENGINE AND GEAR SERVICE DIVISION

GRAFTON, WISCONSIN 53024



TECUMSEH CARBURETOR NOS. 632369, 632380, 632387, 632388, 632389, 632391, 632405, 632420, 632426, 632434, 632466, 632468

ILLUSTRATION SHOWS TYPICAL PARTS ONLY. ORDER BY PART NUMBER. PARTS NOT LISTED ARE SUPPLIED BY OEM.

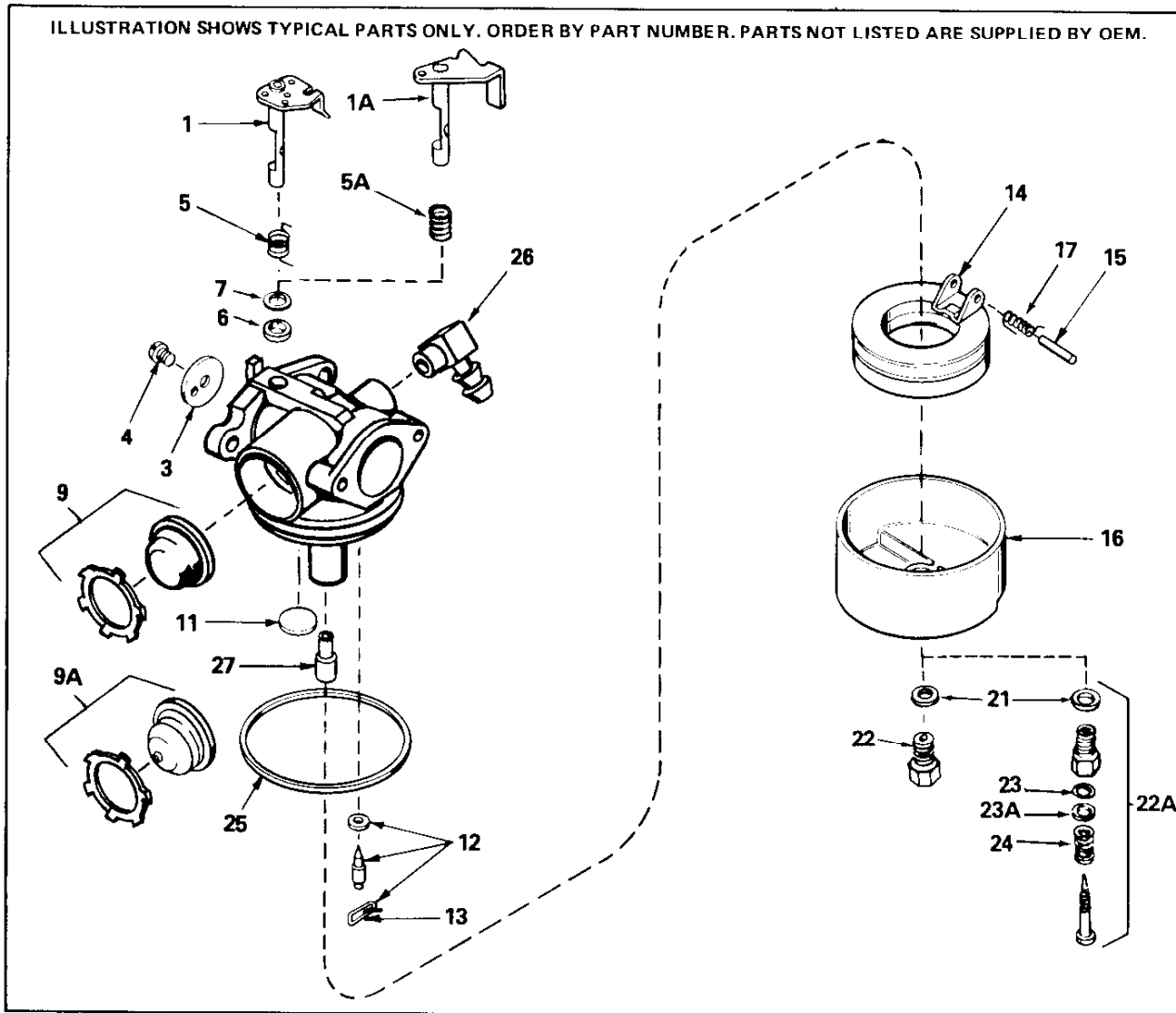

REF. NO.	PART NO.	PART NAME	CARB. NOS.	632369	632380	632387	632388	632389	632391	632405	632420	632426	632434	632466	632468
1	631615	Shaft & Lever Assy., Throttle.....		X	X	X	X	X	X	X	X	X		X	X
1A	632432	Shaft & Lever Assy., Throttle.....											X	X	X
3	631616	Shutter, Throttle.....		X	X	X	X	X	X	X	X	X		X	X
3	631757	Shutter, Throttle.....											X	X	X
4	†650506	Screw, Throttle shutter.....		X	X	X	X	X	X	X	X	X	X	X	X
5	631767	Spring, Return.....		X	X	X	X	X	X	X	X	X		X	X
5A	632169	Spring, Throttle.....											X	X	X
6	631971	Seal, Dust.....		X	X	X	X	X	X	X	X	X		X	X
6	631183	Seal, Dust.....											X	X	X
7	631184	Washer, Flat.....		X	X	X	X	X	X	X	X	X	X	X	X



TECUMSEH PRODUCTS COMPANY
ENGINE AND GEAR SERVICE DIVISION
 GRAFTON, WISCONSIN 53024

FILE IN:
 DIVISION 5
 SECTION A
 Issued April 1984
 Revised December 1986

TECUMSEH CARBURETOR NOS. 632369, 632380, 632387, 632388,
632389, 632391, 632405, 632420, 632426, 632434, 632466, 632468

REF. NO.	PART NO.	PART NAME	CARB. NOS.													
				632369	632380	632387	632388	632389	632391	632405	632420	632426	632434	632466	632468	
9	632047	Bulb & Retainer, Primer.....		X		X	X	X	X		X				X	X
9A	632433	Bulb & Retainer, Primer.....											X		X	
11	631027	Plug, Welch.....		X	X	X	X	X	X	X	X	X	X	X	X	X
12	631021	Inlet Needle, Seat & Clip Assy. (Incl. No. 13).....		X	X	X	X	X	X	X	X	X	X	X	X	X
13	631022	Clip, Inlet needle.....		X	X	X	X	X	X	X	X	X	X	X	X	X
14	632019	Float, Carburetor.....		X	X	X	X	X	X	X	X	X	X	X	X	X
15	631024	Shaft, Float.....		X	X	X	X	X	X	X	X	X	X	X	X	X
16	631700	Bowl, Float.....		X	X	X	X	X	X	X	X			X	X	
16	631867	Bowl, Float.....											X		X	
17	632386	Spring, Float shaft.....											X		X	
21	631334	Gasket, Bowl-to-body.....		X	X	X	X	X	X	X	X				X	X
21	27110	Washer, Fiber.....											X		X	
22	632147	Nut, Float bowl.....		X	X											
22	631937	Nut, Float bowl.....				X										
22	631935	Nut, Float bowl.....					X	X								
22	632106	Nut, Float bowl.....									X					X
22	632421	Nut, Float bowl.....										X				
22	632431	Nut, Float bowl (L.H.).....											X			
22	632435	Nut, Float bowl (L.H.).....												X		
22	632392	Nut, Float bowl.....													X	
22A	632455	Adjusting Screw Assy., Main (Incl. Nos. 21, 23, 23A, 24 & 27).....									X					
23	630740	"O" Ring, Adjusting screw.....									X					
23A	630739	Washer, Flat.....									X					
24	630738	Spring, Adjusting screw.....									X					
25	631028	Gasket, Bowl-to-body.....		X	X	X	X	X	X	X	X	X	X	X	X	X
26	631775	Fitting, Fuel inlet.....			X	X	X	X			X	X	X		X	X
26	631807	Fitting, Fuel inlet.....		X					X		X	X	X		X	
27	632158	Spacer.....		X	X				X		X	X				

†Standard Hardware, can be purchased locally. For complete description see Standard Hardware Identification List.

NOTE: Always check Master Parts Price List for possible replacement numbers.